

Peel-N-Stick Panel Installation Instructions

The following information is provided to enable the user of Hardwire peel-n-stick ballistic panels to install the panels as needed for the application.

Hardwire, LLC
1947 Clarke Avenue
Pocomoke City, MD 21851
(410) 957-3669

Prepare and Prime Panels for VHB Adhesive

1. Wipe down the surface of the armor panel onto which you will apply the VHB adhesive. This ensures the panel surface is free from dust and dirt. This can be done using a rag and bottle of Windex.
2. Paint the surface of the panel using a standard paint brush and the VHB primer provided.
 - **Caution!** Panels should be painted in a well-ventilated area to avoid inhaling primer fumes.
3. Allow primer to dry for approximately 10 – 15 minutes. The surface should appear slightly etched after painting.
4. Repeat Steps 1 – 3 on the surface onto which you attaching the Peel-N-Stick armor panels.
(Examples: wall, door, desk, etc.)

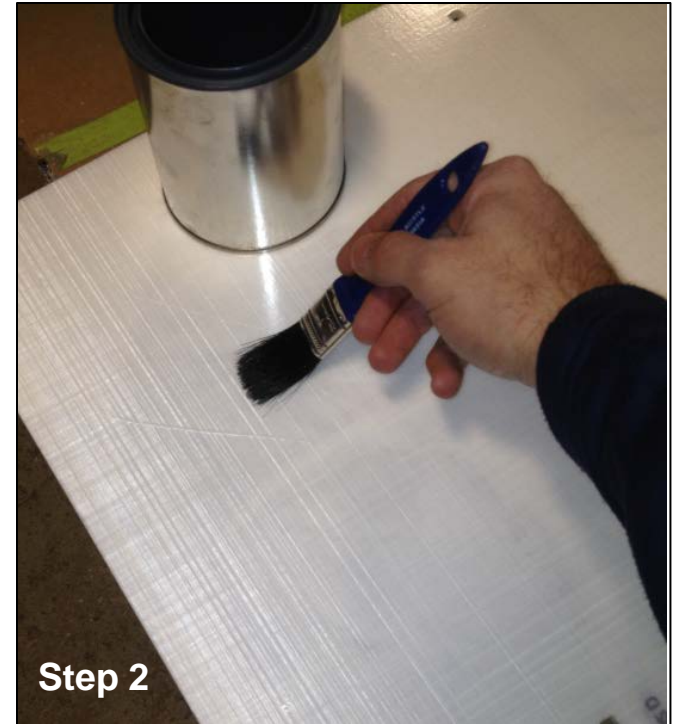

Applying VHB Adhesive

1. Apply 1 inch VHB strips around the entire edge of the of the Peel-N-Stick panel. This should be one on the rear side of the panel. The VHB can be trimmed to length using a sharp razor blade.
2. Using a marker and a framing square make reference marks for applying the VHB tape to the center of the panel. The center VHB striping should meet the edge strips that are already applied.
3. Apply VHB strips every 4 inches down the length of the panel.
 - Note: If a center strip intersects with a cutout in the panel, simply trim the strip and continue a new one after the cutout.
3. Run your thumb or down each strip of VHB to ensure it is making full contact with the panel.

Note: Example VHB application provided on the next sheet.

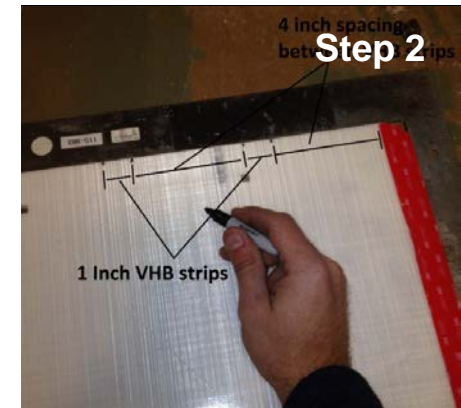

Applying VHB Adhesive Continued

Example Panel (27" X 59.5")

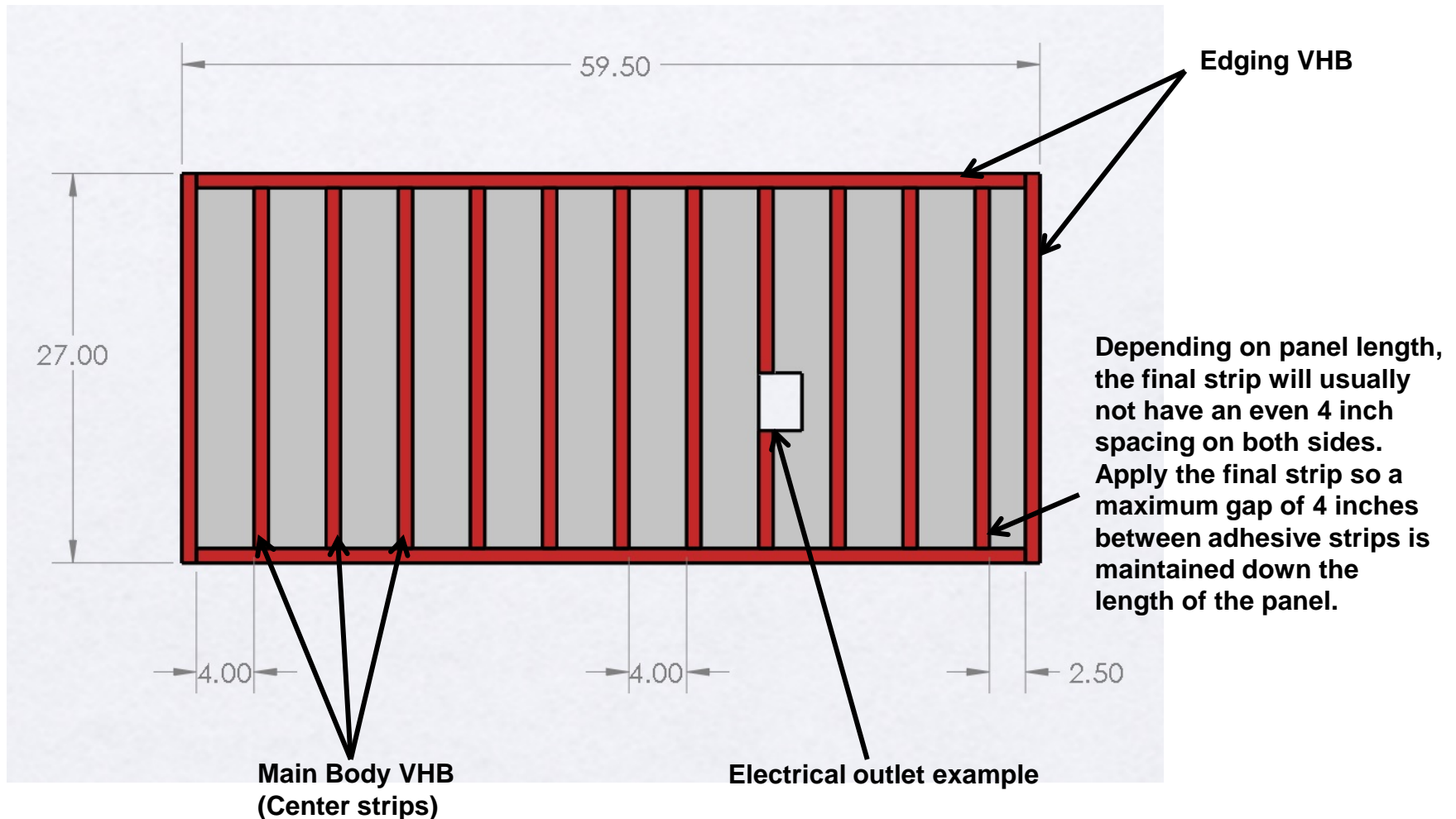

Installing Peel-N-Stick Panels

1. Remove the red release paper from the VHB adhesive strips.
2. Hold the panel over the installation surface (maintaining an inch or so of clearance) before final installation. A second person should scribe reference marks on the installation surface to guide the panel into the desired position.
 - Note: It is important to fully evaluate the position of the panel on the application surface before applying the panel. Be sure that the panel is level and in the desired position before the panel is adhered. Panels are designed for one time application and will be extremely difficult to remove or adjust.
3. Apply the panel to the desired surface. Press the panel with the palm of the hand to ensure the adhesive makes full contact with the application surface.



Peel-N-Stick Door Panel shown in example above.